

Block A Floor Plans.

BLOCK

A

TYPE A

FLOOR AREA
UNIT = 1,184 ft²

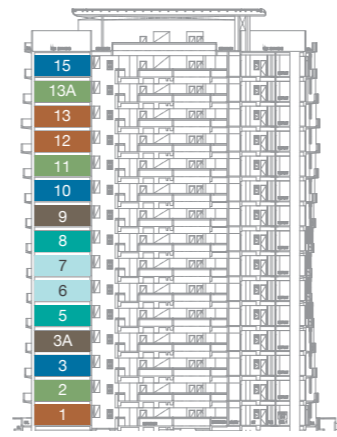

BLOCK

A

TYPE B

FLOOR AREA
UNIT = 990 ft²

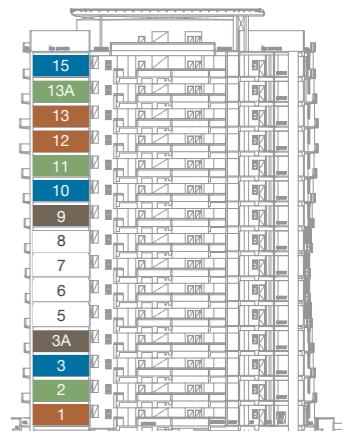

- LEVEL 5, 8
BALCONY = 324 ft²
TOTAL FLOOR AREA = 1507 ft²
- LEVEL 6, 7
BALCONY = 339 ft²
TOTAL FLOOR AREA = 1523 ft²
- LEVEL 2, 11, 13A
BALCONY = 239 ft²
TOTAL FLOOR AREA = 1423 ft²
- LEVEL 3, 10, 15
BALCONY = 272 ft²
TOTAL FLOOR AREA = 1456 ft²
- LEVEL 1, 12, 13
BALCONY = 200 ft²
TOTAL FLOOR AREA = 1384 ft²
- LEVEL 3A, 9
BALCONY = 300 ft²
TOTAL FLOOR AREA = 1484 ft²

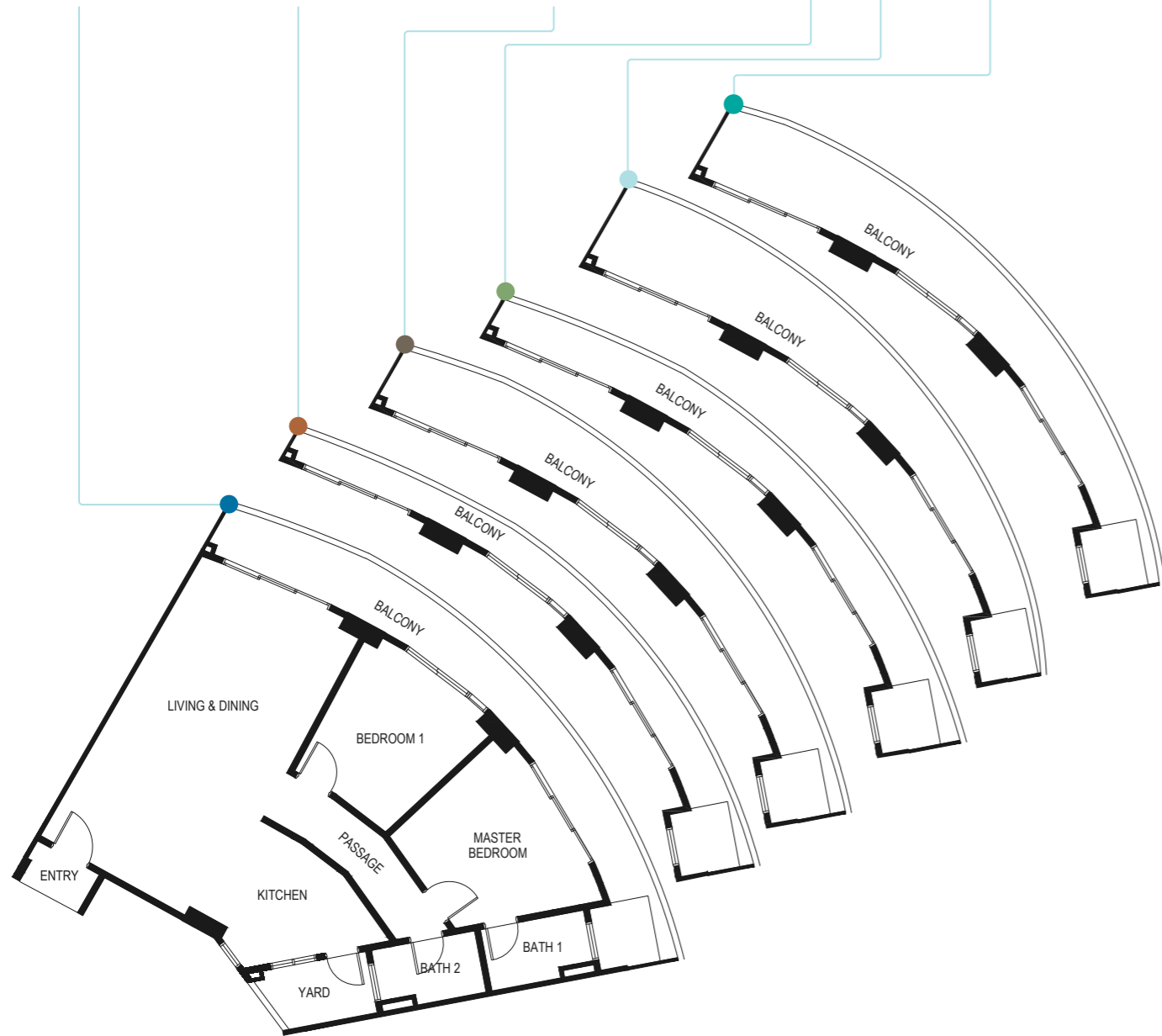

- LEVEL 1, 12, 13
BALCONY = 299 ft²
TOTAL FLOOR AREA = 1289 ft²
- LEVEL 3A, 9
BALCONY = 183 ft²
TOTAL FLOOR AREA = 1173 ft²
- LEVEL 3, 10, 15
BALCONY = 244 ft²
TOTAL FLOOR AREA = 1235 ft²
- LEVEL 2, 11, 13A
BALCONY = 301 ft²
TOTAL FLOOR AREA = 1291 ft²



Note : • Subject to variations, modifications and substitutions as may be required by the Authorities or recommended by Architect or Engineer.
• Subject to the final survey by the licensed land surveyor.

Note : • Subject to variations, modifications and substitutions as may be required by the Authorities or recommended by Architect or Engineer.
• Subject to the final survey by the licensed land surveyor.

BLOCK

A

TYPE B1

FLOOR AREA
UNIT = 873 ft²

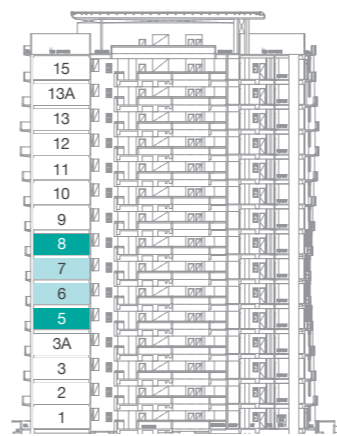

BLOCK

A

TYPE C

FLOOR AREA
UNIT = 1104 ft²

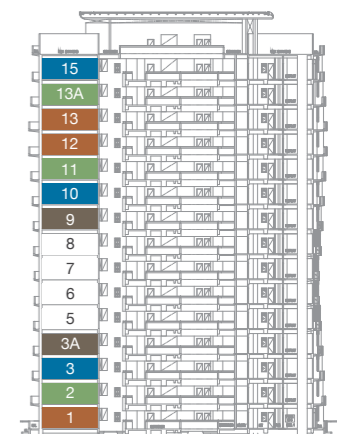

LEVEL 5, 8
BALCONY = 238 ft²
TOTAL FLOOR AREA = 1111 ft²

LEVEL 6, 7
BALCONY = 174 ft²
TOTAL FLOOR AREA = 1047 ft²

LEVEL 2, 11, 13A
BALCONY = 200 ft²
TOTAL FLOOR AREA = 1305 ft²

LEVEL 1, 12, 13
BALCONY = 209 ft²
TOTAL FLOOR AREA = 1314 ft²

LEVEL 3A, 9
BALCONY = 149 ft²
TOTAL FLOOR AREA = 1252 ft²

LEVEL 3, 10, 15
BALCONY = 172 ft²
TOTAL FLOOR AREA = 1277 ft²



Note : • Subject to variations, modifications and substitutions as may be required by the Authorities or recommended by Architect or Engineer.
• Subject to the final survey by the licensed land surveyor.

Note : • Subject to variations, modifications and substitutions as may be required by the Authorities or recommended by Architect or Engineer.
• Subject to the final survey by the licensed land surveyor.

TYPE C1

FLOOR AREA
UNIT = 991 ft²

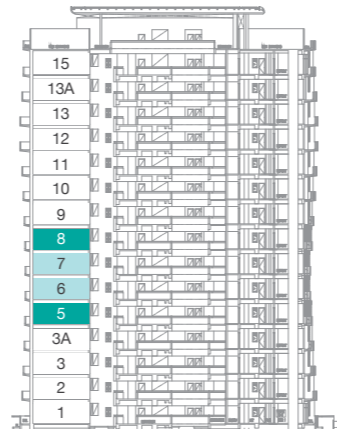

TYPE D

FLOOR AREA
UNIT = 1566 ft²

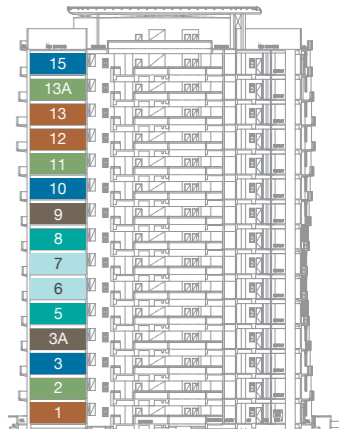

LEVEL 6, 7
BALCONY = 231 ft²
TOTAL FLOOR AREA = 1222 ft²

LEVEL 5, 8
BALCONY = 245 ft²
TOTAL FLOOR AREA = 1236 ft²

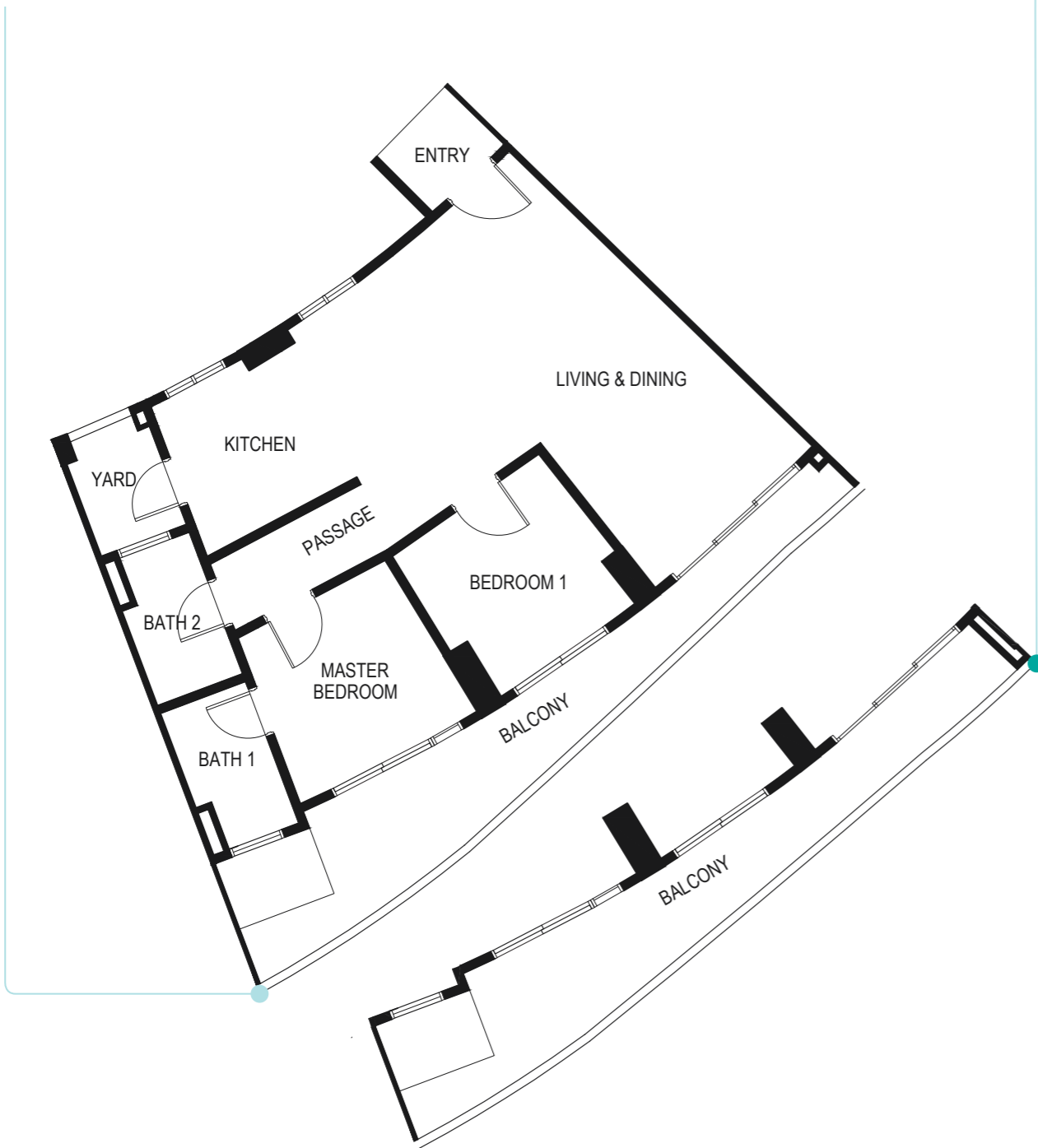

LEVEL 1, 12, 13
BALCONY = 363 ft²
TOTAL FLOOR AREA = 1929 ft²

LEVEL 2, 11, 13A
BALCONY = 420 ft²
TOTAL FLOOR AREA = 1986 ft²

LEVEL 3, 10, 15
BALCONY = 472 ft²
TOTAL FLOOR AREA = 2038 ft²

LEVEL 6, 7
BALCONY = 631 ft²
TOTAL FLOOR AREA = 2197 ft²

LEVEL 5, 8
BALCONY = 579 ft²
TOTAL FLOOR AREA = 2145 ft²

LEVEL 3A, 9
BALCONY = 525 ft²
TOTAL FLOOR AREA = 2092 ft²

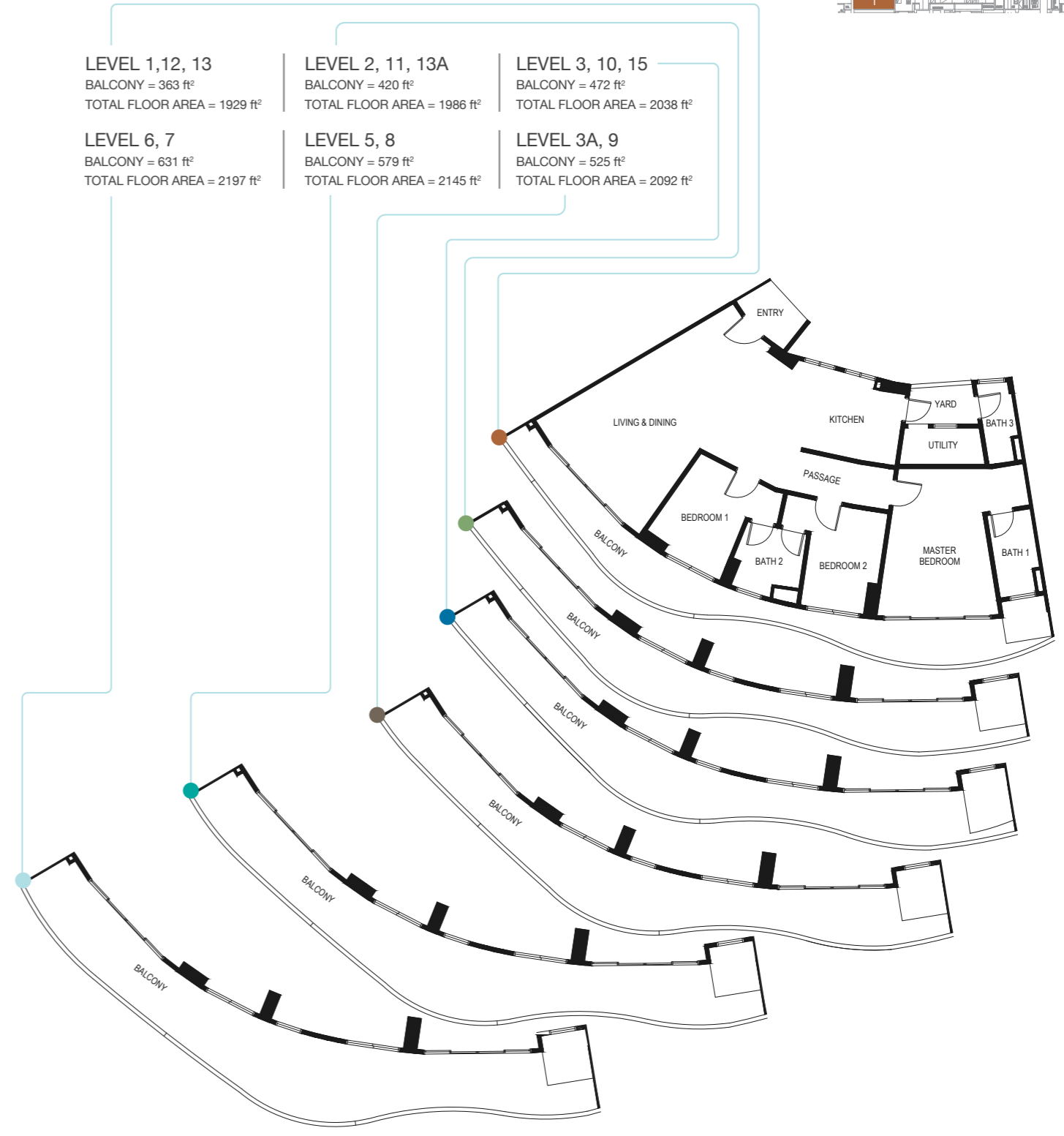

Note : • Subject to variations, modifications and substitutions as may be required by the Authorities or recommended by Architect or Engineer.
• Subject to the final survey by the licensed land surveyor.

Note : • Subject to variations, modifications and substitutions as may be required by the Authorities or recommended by Architect or Engineer.
• Subject to the final survey by the licensed land surveyor.

TYPE E

FLOOR AREA
UNIT = 1014 ft²

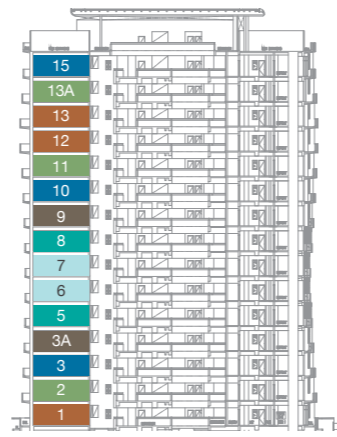

LEVEL 3A, 9 BALCONY = 250 ft ² TOTAL FLOOR AREA = 1264 ft ²	LEVEL 5, 8 BALCONY = 234 ft ² TOTAL FLOOR AREA = 1248 ft ²	LEVEL 6, 7 BALCONY = 217 ft ² TOTAL FLOOR AREA = 1231 ft ²
LEVEL 3, 10, 15 BALCONY = 263 ft ² TOTAL FLOOR AREA = 1277 ft ²	LEVEL 2, 11, 13A BALCONY = 273 ft ² TOTAL FLOOR AREA = 1287 ft ²	LEVEL 1, 12, 13 BALCONY = 280 ft ² TOTAL FLOOR AREA = 1294 ft ²

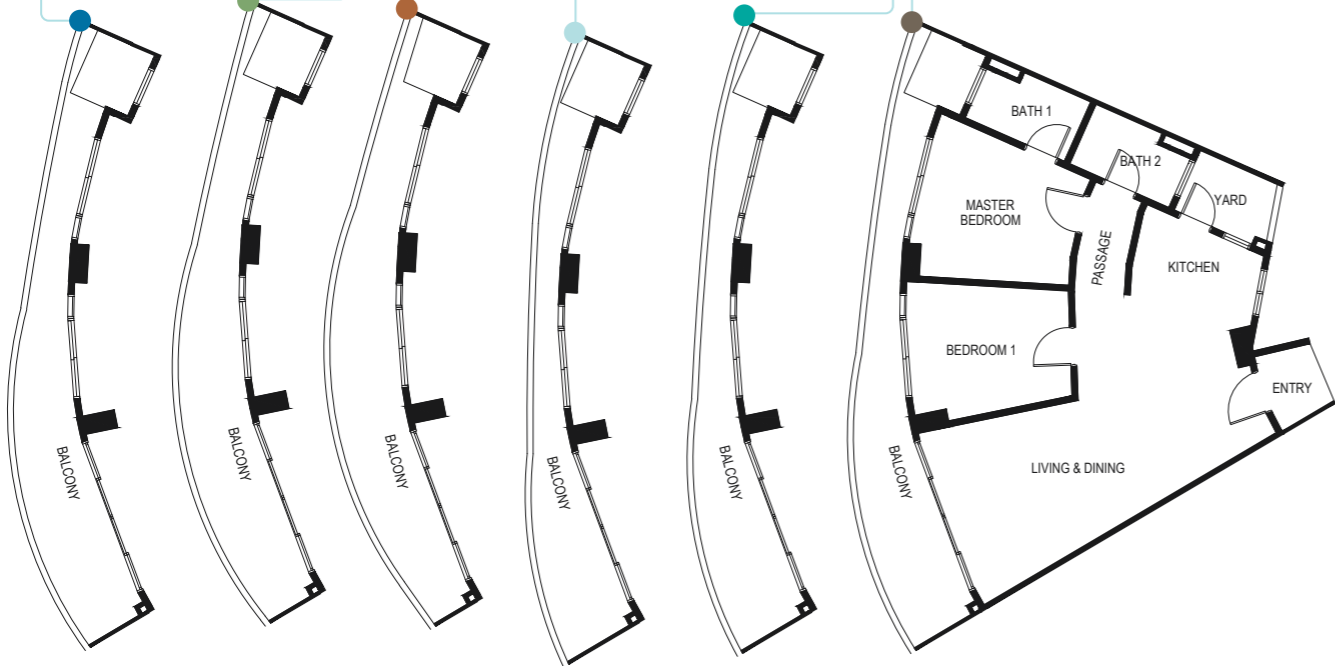

Note : • Subject to variations, modifications and substitutions as may be required by the Authorities or recommended by Architect or Engineer.
 • Subject to the final survey by the licensed land surveyor.

TYPE F

FLOOR AREA
UNIT = 1123 ft²

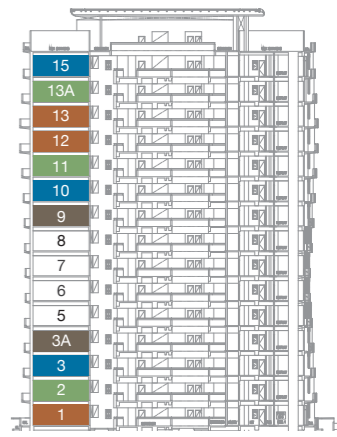

LEVEL 3A, 9 BALCONY = 258 ft ² TOTAL FLOOR AREA = 1380 ft ²	LEVEL 1, 12, 13 BALCONY = 295 ft ² TOTAL FLOOR AREA = 1418 ft ²	LEVEL 2, 11, 13A BALCONY = 277 ft ² TOTAL FLOOR AREA = 1400 ft ²	LEVEL 3, 10, 15 BALCONY = 258 ft ² TOTAL FLOOR AREA = 1380 ft ²
--	--	---	--



Note : • Subject to variations, modifications and substitutions as may be required by the Authorities or recommended by Architect or Engineer.
 • Subject to the final survey by the licensed land surveyor.

TYPE F1

FLOOR AREA

UNIT = 1076 ft²

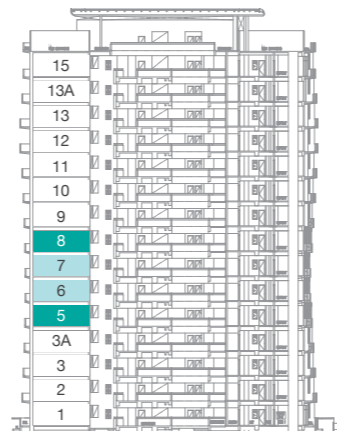

Floor Layout

LEVEL 5, 8
BALCONY = 260 ft²
TOTAL FLOOR AREA = 1336 ft²

LEVEL 6, 7
BALCONY = 235 ft²
TOTAL FLOOR AREA = 1311 ft²

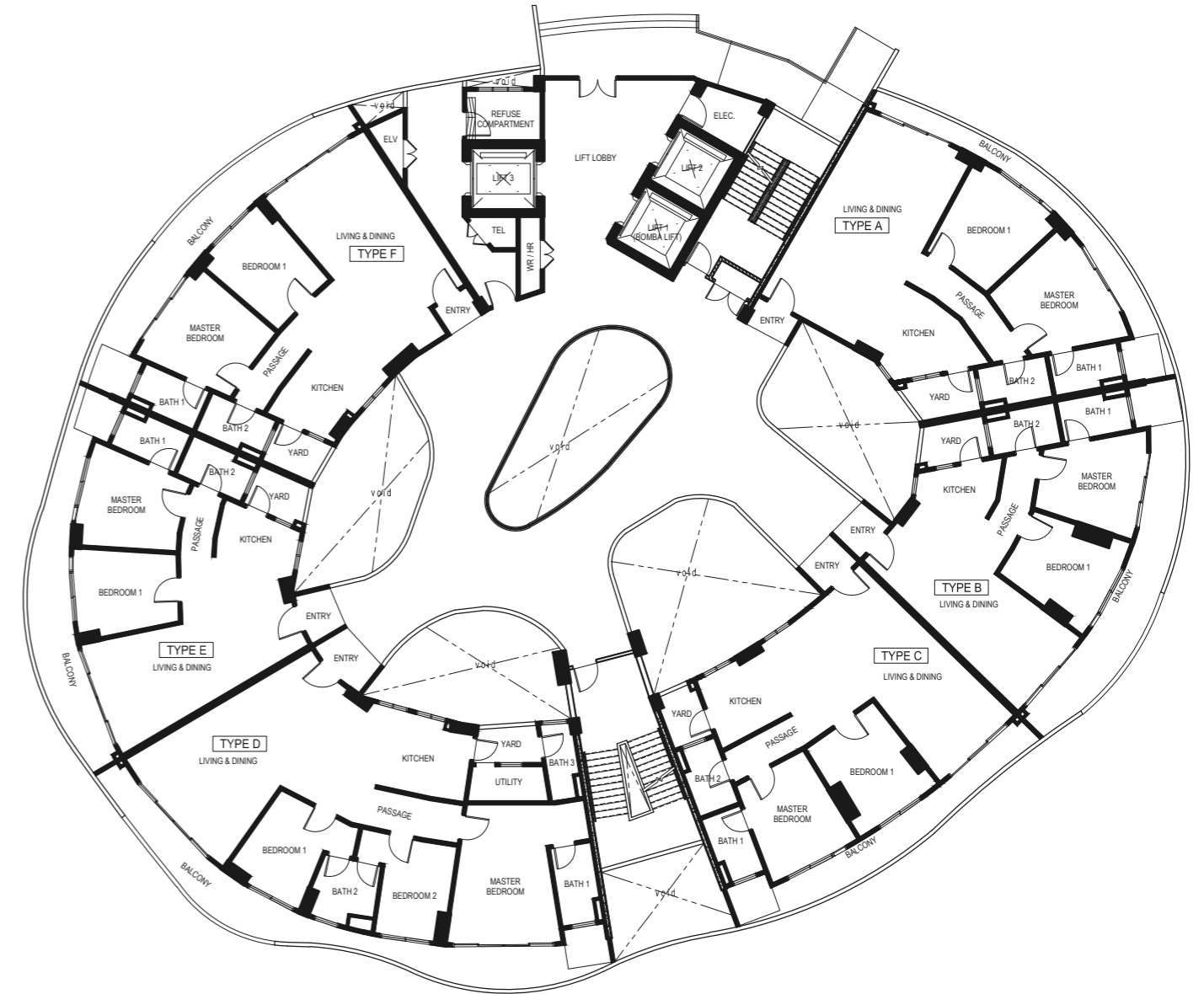
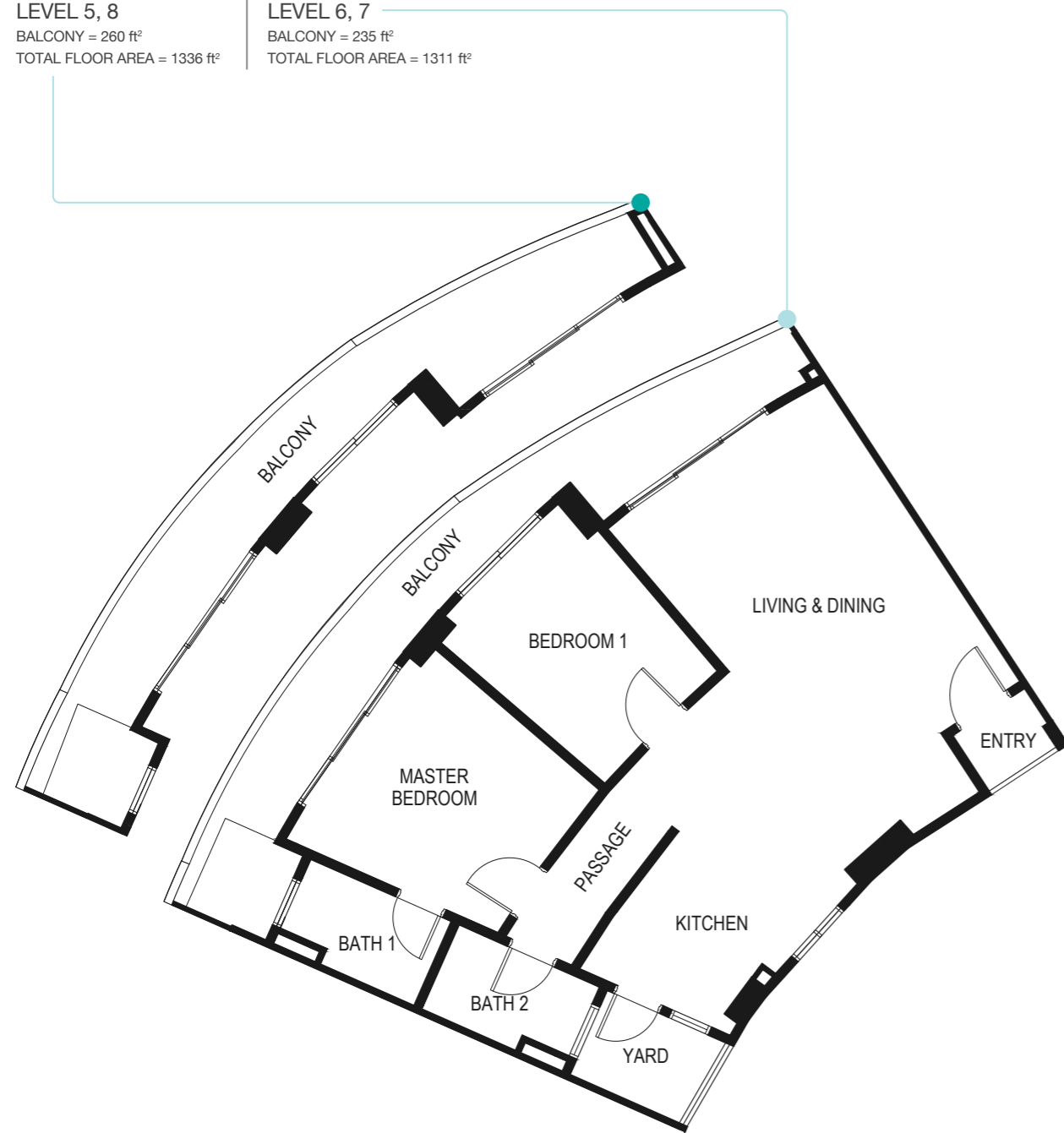

Note :
 • Subject to variations, modifications and substitutions as may be required by the Authorities or recommended by Architect or Engineer.
 • Subject to the final survey by the licensed land surveyor.



SCALE 1:1000

O2 Residence Landscape Master Plan (Ground & Podium)

- | | | | | |
|-------------------------|-----------------------|--|--------------------------|--------------------------|
| 1 Canopy Walk | 6 Garden Pavilion | 12 Organic Decomposer | 17 Outdoor Gym | 23 Outdoor Activity Area |
| 2 Tree House | 7 Herb & Spice Garden | 13 Sauna | 18 Floating island | |
| 3 Yoga Deck | 8 Eco Pool | 14 Function/Party Zone | 19 Audio and Visual Room | 24 Jogging Track |
| 4 Children's Playground | 9 Wading Pool | 15 Bubbling Pool/Water Recreation Area | 20 Water Recreation Area | 25 Tai Chi Zone |
| 5 Sand Pit | 10 Swimming Pool | 16 Scented Garden | 21 Gymnasium | 26 Reflexology Path |
| | 11 BBQ Area | | 22 Bicycle Trail | 27 Chess Zone |

Additional amenities:

- Cafeteria Area
- Games Room
- Music Room
- Recycle Area
- Community Library
- Childcare Centre
- Convenient Store
- Multipurpose Hall
- Bicycle Parking Area
- Launderette

Perfect Eagle Development Sdn Bhd (574362-W)
 No. 30 & 32, Block A, Jalan PUJ 1/43, PUJ 1, Aman Suria Damansara | Tel: 603 - 7803 1626 | Fax: 603 - 7804 2299 | Website: www.ped99.com.my | Developer's License No.: 9756-3/12-2017/1767 - Validity From: 26/12/2012 - 25/12/2017 - Advertising & Sales Permit No.: 9758-3/17/1/2014(01) - Validity From: 18/01/2013 - 17/01/2014 - Approving Authority: Majlis Perbandaran Subang Jaya (MPSJ) - Building Plan Approval No.: MPSJ/BGN/KW/C-9/79 - Tenure: Leasehold 99 years (Expiry 27th May 2097) - Land Encumbrances: Nil - Expected Date of Completion: 42 months from SPA (September 2016) - Bumiputera Discount: 7% - O2 Residence: Block C - Service Apartment - Total Units: 84 - Price: Type A (12 Units): RM 528,800 (Min.) - RM 632,800 (Max.) - Price: Type B (12 Units): RM 587,800 (Min.) - RM 693,800 (Max.) - Price: Type C (12 Units): RM 795,800 (Min.) - RM 851,800 (Max.) - Price: Type D (6 Units): RM 559,800 (Min.) - RM 643,800 (Max.) - Price: Type D1 (6 Units): RM 589,800 (Min.) - RM 673,800 (Max.) - Price: Type E (12 Units): RM 504,800 (Min.) - RM 589,800 (Max.) - Price: Type F (12 Units): RM 552,800 (Min.) - RM 621,800 (Max.) - Price: Type G (12 Units): RM 660,800 (Min.) - RM 834,800 (Max.) - O2 Residence Block A - Service Apartment - Total Units: 90 - Price: Type A (15 Units): RM 691,800 (Min.) - RM 793,800 (Max.) - Price: Type B (11 Units): RM 588,800 (Min.) - RM 711,800 (Max.) - Price: Type B1 (4 Units): RM 559,800 (Min.) - RM 667,800 (Max.) - Price: Type C (11 Units): RM 629,800 (Min.) - RM 740,800 (Max.) - Price: Type C1 (4 Units): RM 633,800 (Min.) - RM 655,800 (Max.) - Price: Type D (15 Units): RM 931,800 (Min.) - RM 1,108,800 (Max.) - Price: Type E (15 Units): RM 631,800 (Min.) - RM 699,800 (Max.) - Price: Type F (11 Units): RM 685,800 (Min.) - RM 758,800 (Max.) - Price: Type F1 (4 Units): RM 678,800 (Min.) - RM 700,800 (Max.) - The information contained herein is subject to change without notification as may be required by relevant authorities or the developer's consultants and cannot form part of an offer or contract. All illustrations and pictures are artist's impressions only. The items are subject to variations, modifications and substitutions as may be recommended by the Company's consultants and / or relevant Approving Authorities.